

**Mark A. Blasch R.A.,  
L.L.C.**

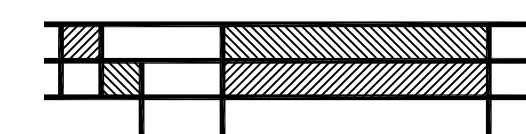

**Mark A. Blasch**  
Registered Architect

10 Crescent Ave  
PO Box 621  
Rocky Hill, NJ 08553

(609) 683-4032  
mblasch@verizon.net

This drawing, the design it illustrates and all concepts herein are the sole property of Mark A. Blasch Registered Architect LLC. No part of this drawing or design may be reproduced or transmitted in any form or by any means, electronic or mechanical, including photocopying, recording or by any information storage and retrieval system without written permission from the owner, Mark A. Blasch Registered Architect LLC.

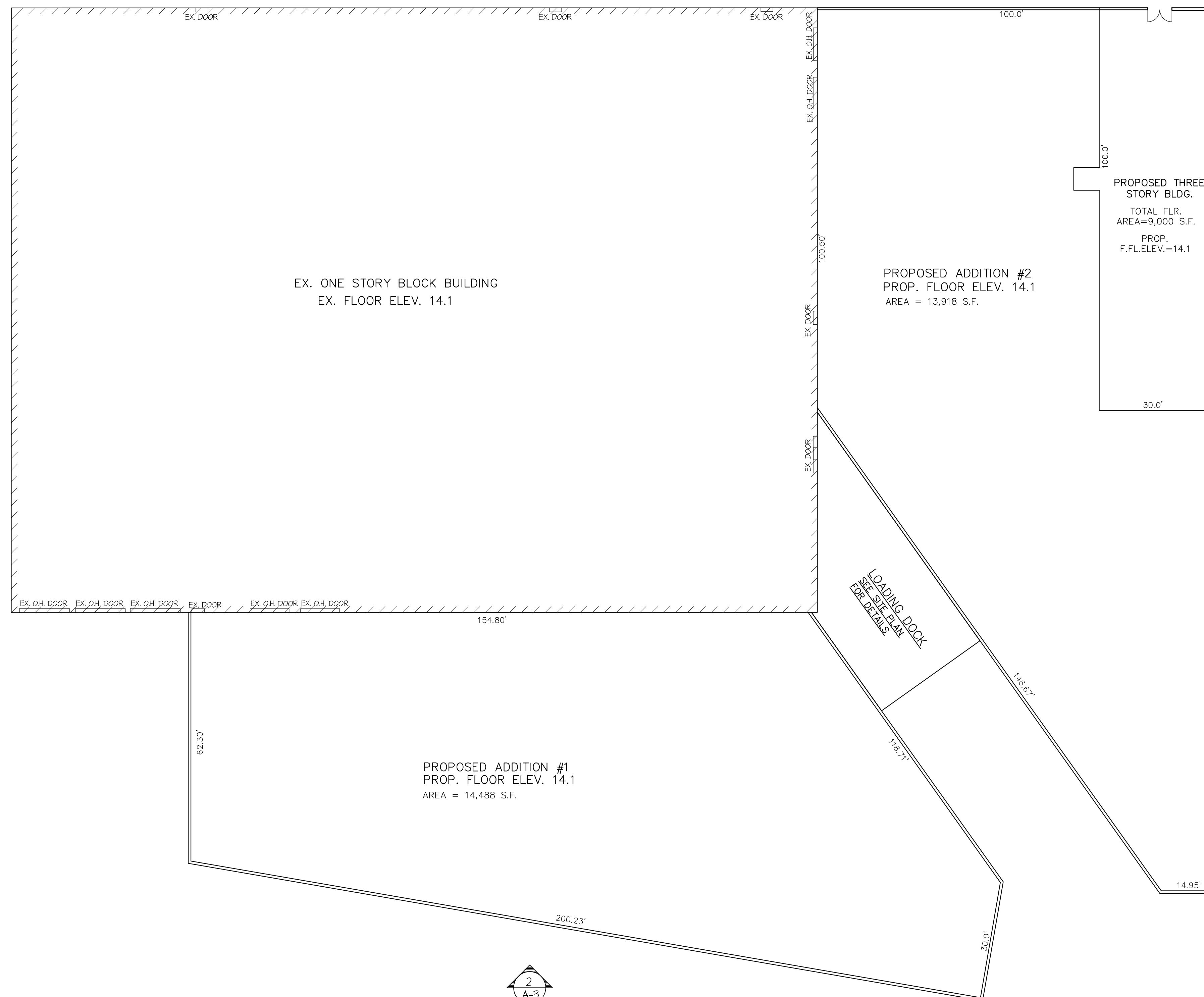

① **OVERALL FLOOR PLAN**  
SCALE: 1/16" = 1'-0"

PROJECT: PROPOSED THREE STORY BUILDING	
LOCATION: 340A TREMLEY POINT ROAD LINDEN, N.J. 07036	
DRAWING TITLE: OVERALL FLOOR PLANS	
OWNER: JVM SALES CORPORATION	
DATE 02/28/20	SHEET NO. A-1