

DATE	NAME	REV.
12/31/93	MATTHEW L. MARTINI L.S. 30088	1
12/31/95	MATTHEW L. MARTINI L.S. 30088	2

KEY MAP 19

KEY MAP 14

KEY MAP 8

KEY MAP 16

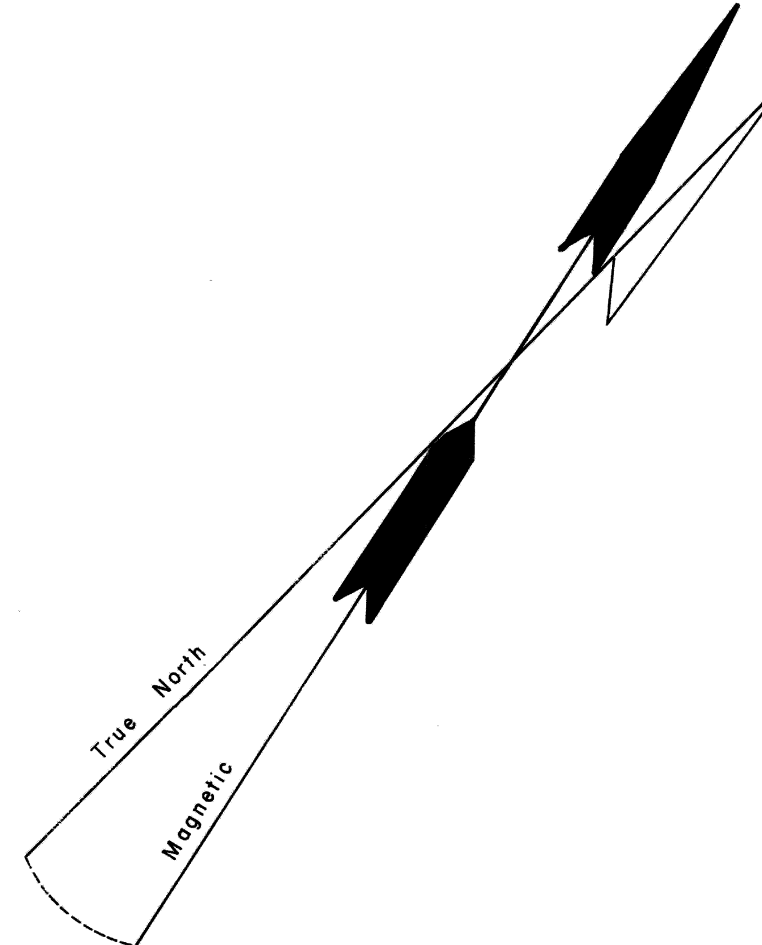
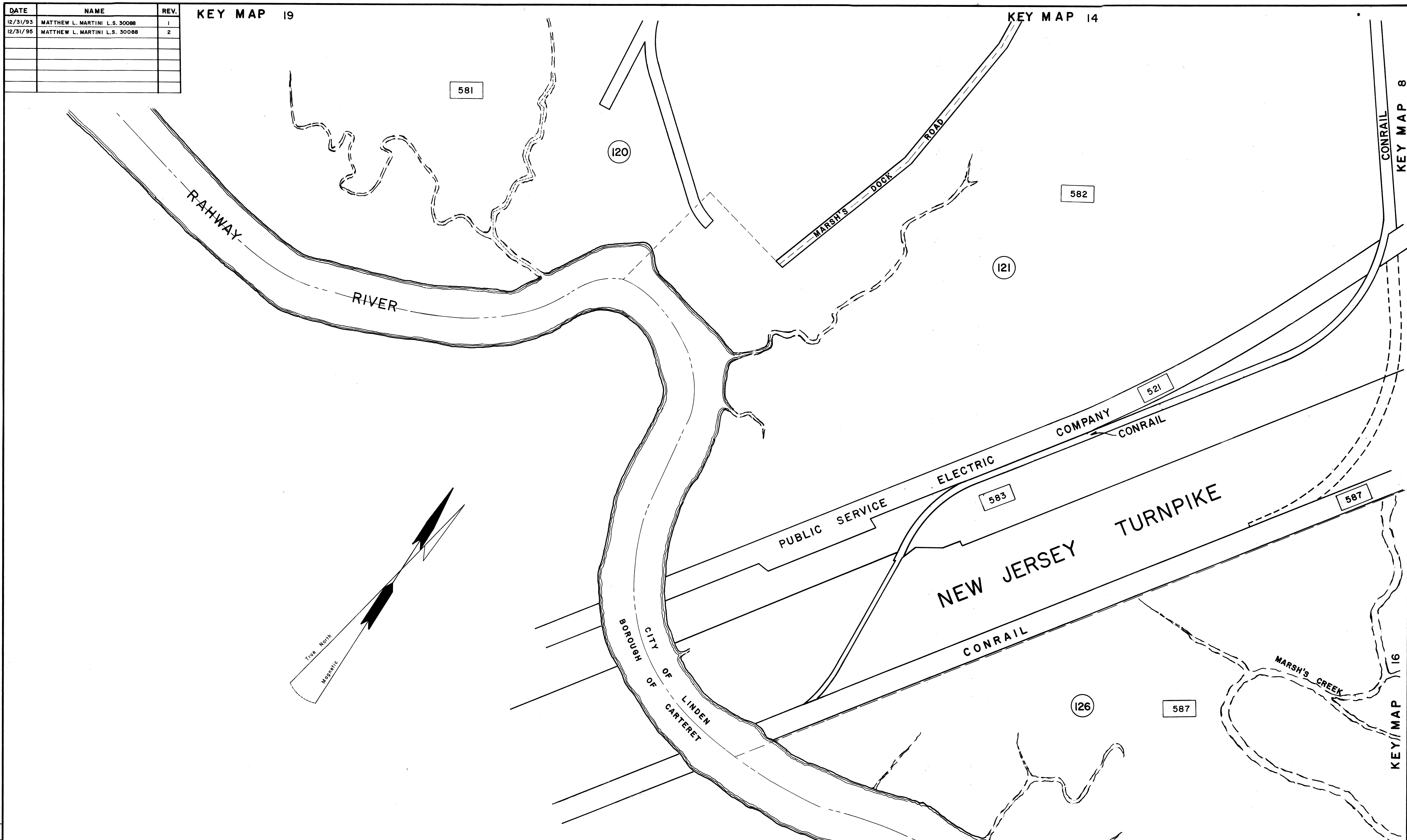

LEGEND

- DETAIL SHEET NUMBER
- BLOCK NUMBER
- SHEET LIMIT

I HEREBY CERTIFY THAT THIS MAP AS NOTED IN REVISION BLOCK HAS BEEN REVISED UNDER MY IMMEDIATE SUPERVISION, AND COMPLIES WITH THE LAWS OF THE STATE OF NEW JERSEY.

Matthew L. Martini
MATTHEW L. MARTINI, PROFESSIONAL LAND SURVEYOR LIC. No. 30088

CERTIFIED to the City of Linden that the block & lot numbers, title blocks & sheet numbers are in accordance with Agreement dated February 13, 1973

Paul J. Emilius
N.J. Lic. Land Surveyor No. 11363

NEW JERSEY DEPARTMENT OF THE TREASURY
DIVISION OF TAXATION
PUBLIC UTILITY TAX BUREAU
APPROVED AS A TAX MAP PURSUANT TO THE PROVISIONS OF CHAPTER 12, L.A.S. 1913 AND BY THE DIRECTOR DIVISION OF TAXATION
BY *John A. Ziemian* L.S. 30088
DATE JAN 16 1974 SERIAL No. 529

TAX MAP
CITY OF LINDEN
UNION COUNTY, NEW JERSEY
SCALE: 1"=200' DATE: FEBRUARY 1973
JOHN A. ZIEMIAN - CITY ENGINEER
THOMAS J. STRAPP - ASST. CITY ENGINEER

DRAFTING ONLY UPDATED BY PAUL J. EMILIUS & ASSOCIATES

REV.	DATE	DESCRIPTION	BY